

ITEM NO.	DESCRIPTION	QTY.
1	Flashing, 9" x 12" x .040", AL*	1
2	Base Block, Conduit Mounts, AL 6061-T6*	1
3	Sealing Washer, 1/4" ID X 7/8" OD, EPDM Bonded SS	1
4	Lag Screw, Hex Head, 1/4" x 2-1/2", 18-8 SS	1

**Available in mill, clear anodized, and dark bronze finishes.*

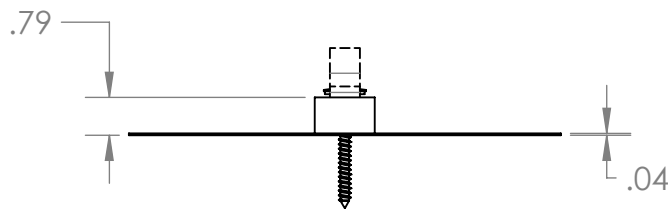
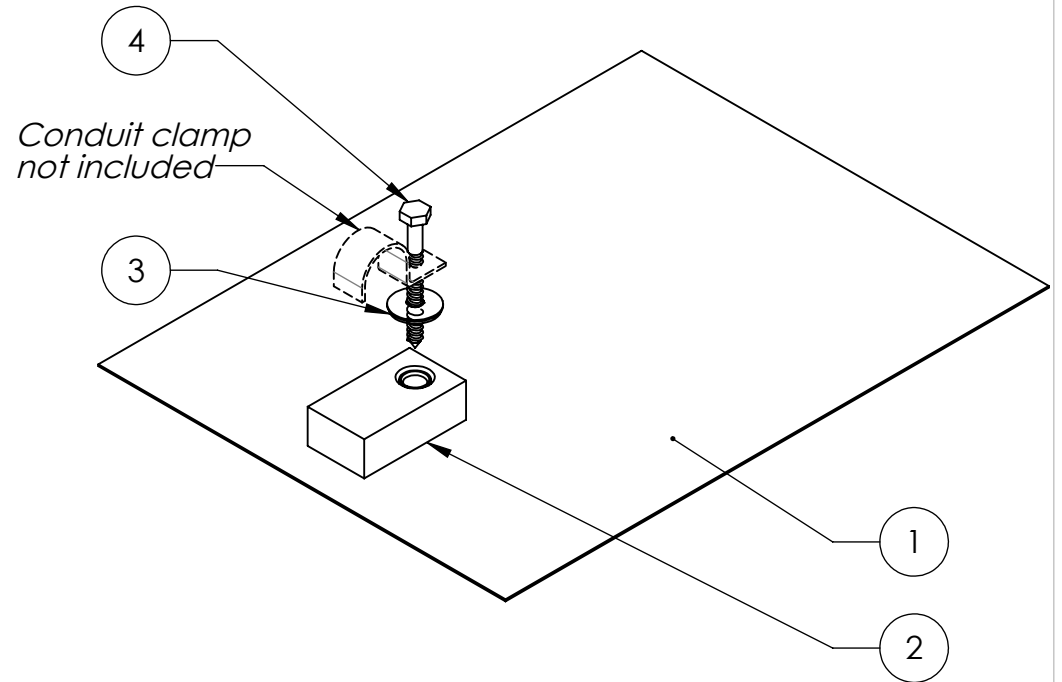
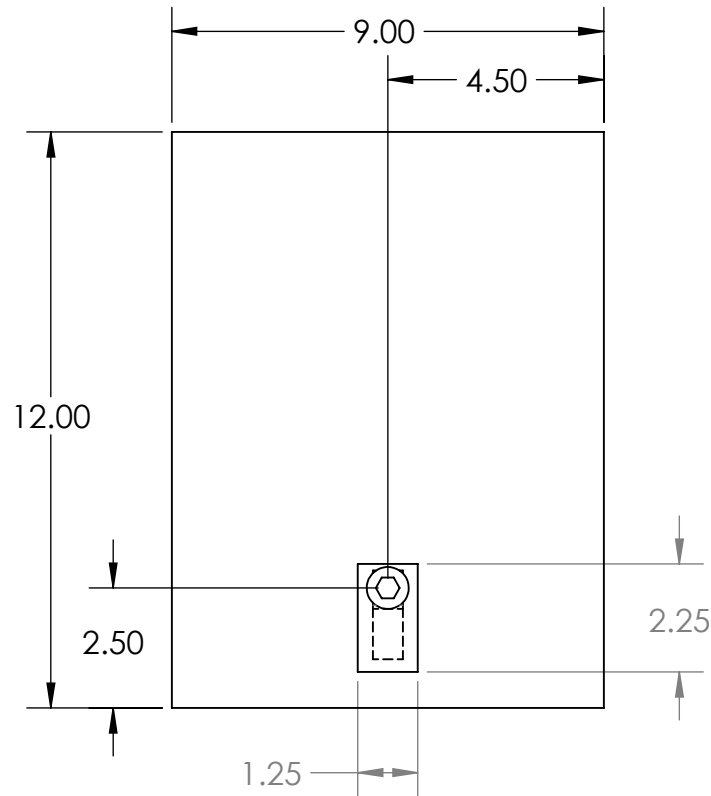

Quick Mount PV[®]

TITLE: **QMCC: Classic Conduit Composition Mount**

UNLESS OTHERWISE SPECIFIED: DIMENSIONS ARE IN INCHES TOLERANCES: FRACTIONAL ± 1/16 TWO PLACE DECIMAL ±.02 THREE PLACE DECIMAL ±.005	SIZE A	DRAWN BY: JDA	REV 1
	SCALE: 1:4	DATE: 5/7/2012	WEIGHT: 0.62

SHEET 1 OF 1